

SINGLE SINE

PM

UNIAXIAL SINE TABLE

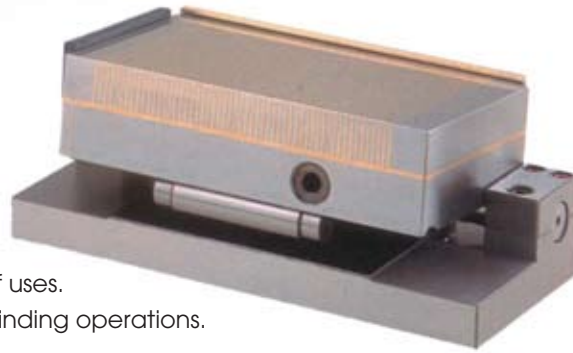

FEATURES

- A positive locking device is mounted on the base.
- Easy to use and a large effective area is provided for machining the works.
- This device provides positive locking at any angle without distortion.
- Constructed of hardened alloy tool steel. Angle precision 0.007/100mm.

APPLICATIONS

- Flat type for wide range of uses.
- Ideal for high accuracy grinding operations.

Product Code : SS All dimensions are in mm according to the effective magnetic area.

| Model | L | B | C | D | E | A | P | Tilting Degrees | (kg) |
|-------|-----|-----|----|-----|----|-----|---------|-----------------|------|
| 10175 | 175 | 100 | 86 | 75 | 48 | 225 | 2 | 0-60° | 11.5 |
| 1515 | 150 | 150 | | 100 | | 200 | 0.5+1.5 | | 15 |
| 1530 | 300 | 150 | | 100 | | 350 | 4 | | 32 |
| 12525 | 250 | 125 | | 75 | | 300 | 1+3 | | 19.5 |

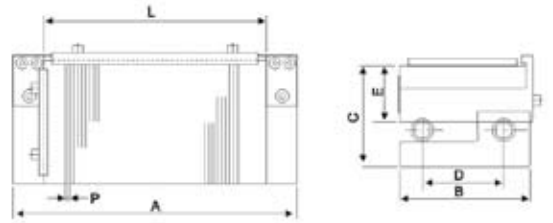

Due to continuous upgradation in design there could be changes in specification. Other sizes on request. Before ordering, contact Lifton Magnets or your nearest dealer to confirm the suitability of this model for your application.

DOUBLE SINE

PM

BI-AXIAL SINE TABLE

FEATURES

- A positive locking device is mounted on the base.
- Easy to use and a large effective area is provided for machining the works.
- Constructed of hardened alloy tool steel.
- Effective area of compound sine chuck is enlarged by employing the thin type permanent magnetic chuck.
- This increases the range of types usable by tilting works in length, breadth or composite angle.
- Double way sine plate, can grind two way angle at the same time.
- Angle precision 0.007/100mm.

APPLICATIONS

- Flat type for wide range of uses.
- Ideal for high accuracy grinding operations.
- This is suitable for high precision angle grinding on a grinding machine and so on.

Product Code : SS All dimensions are in mm according to the effective magnetic area.

| Model | L1 | L2 | L3 | H | B1 | B2 | P | Tilting Degrees | Weight (kg) |
|--------|-----|-----|-----|-----|-----|-----|---------|-----------------|-------------|
| 10175A | 100 | 205 | 175 | 120 | 75 | 100 | 0.5+1.5 | 0-45° | 12 |
| 1515A | 100 | 180 | 150 | 125 | 100 | 150 | | | 16 |
| 1530A | 150 | 330 | 300 | 125 | 100 | 150 | | | 32.5 |
| 10175 | 100 | 225 | 175 | 110 | 75 | 100 | 1+3 | 0-60° | 12.6 |
| 1515 | 100 | 200 | 150 | 115 | 100 | 150 | | | 17 |
| 1530 | 150 | 300 | 300 | 115 | 100 | 150 | | | 34.5 |

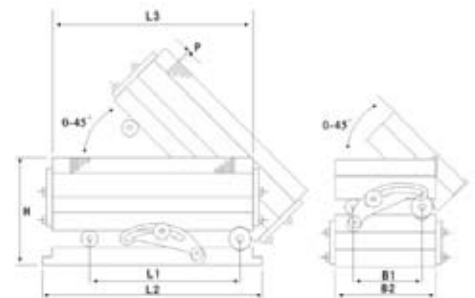

Due to continuous upgradation in design there could be changes in specification. Other sizes on request. Before ordering, contact Lifton Magnets or your nearest dealer to confirm the suitability of this model for your application.

