

# SINGLE SINE

PM

## UNIAXIAL SINE TABLE

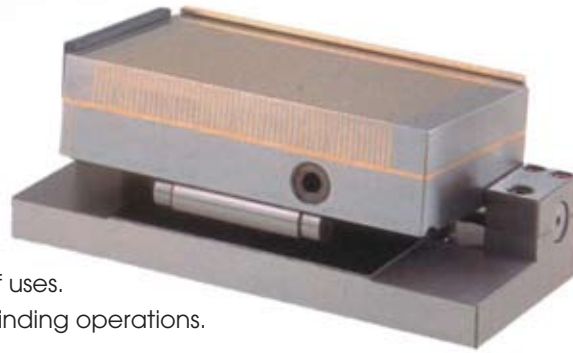

### FEATURES

- A positive locking device is mounted on the base.
- Easy to use and a large effective area is provided for machining the works.
- This device provides positive locking at any angle without distortion.
- Constructed of hardened alloy tool steel. Angle precision 0.007/100mm.

### APPLICATIONS

- Flat type for wide range of uses.
- Ideal for high accuracy grinding operations.

Product Code : SS All dimensions are in mm according to the effective magnetic area.

Model	L	B	C	D	E	A	P	Tilting Degrees	(kg)
10175	175	100	86	75	48	225	2	0-60°	11.5
1515	150	150		100		200			0.5+1.5
1530	300	150		100		350	4		
12525	250	125		75		300	1+3		19.5

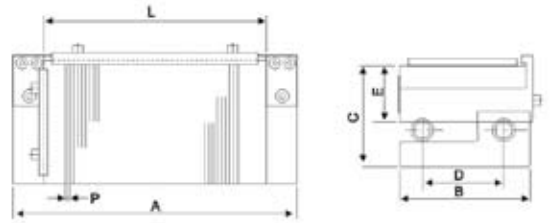

Due to continuous upgradation in design there could be changes in specification. Other sizes on request. Before ordering, contact Lifton Magnets or your nearest dealer to confirm the suitability of this model for your application.

# DOUBLE SINE

PM

## BI-AXIAL SINE TABLE

### FEATURES

- A positive locking device is mounted on the base.
- Easy to use and a large effective area is provided for machining the works.
- Constructed of hardened alloy tool steel.
- Effective area of compound sine chuck is enlarged by employing the thin type permanent magnetic chuck.
- This increases the range of types usable by tilting works in length, breadth or composite angle.
- Double way sine plate, can grind two way angle at the same time.
- Angle precision 0.007/100mm.

### APPLICATIONS

- Flat type for wide range of uses.
- Ideal for high accuracy grinding operations.
- This is suitable for high precision angle grinding on a grinding machine and so on.

Product Code : SS All dimensions are in mm according to the effective magnetic area.

Model	L1	L2	L3	H	B1	B2	P	Tilting Degrees	Weight (kg)
10175A	100	205	175	120	75	100	0.5+1.5	0-45°	12
1515A	100	180	150	125	100	150			16
1530A	150	330	300	125	100	150			32.5
10175	100	225	175	110	75	100	1+3	0-60°	12.6
1515	100	200	150	115	100	150			17
1530	150	300	300	115	100	150			34.5

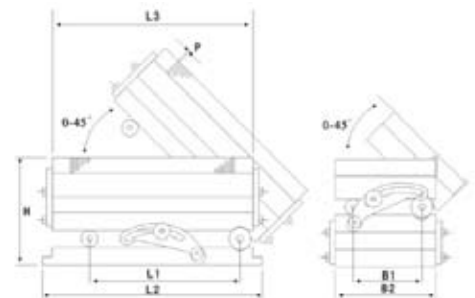

Due to continuous upgradation in design there could be changes in specification. Other sizes on request. Before ordering, contact Lifton Magnets or your nearest dealer to confirm the suitability of this model for your application.

